



File Ref: 15/3/12-14/Erf\_1819, 1820

Enquiries:  
Mr HL Olivier

8 January 2026

CK Rumboll & Partners  
PO Box 211  
MALMESBURY  
7299

By Registered Mail

Dear Sir/Madam

### **PROPOSED CONSOLIDATION OF ERVEN 1819 & 1820, YZERFONTEIN**

Your application with reference YZER/14882/NJdK, dated 16 October 2025, on behalf of R Steenkamp & DCW Edwards, regarding the subject refers.

By virtue of the authority delegated to the Senior Manager: Development Management in terms of Council Decision No. 4.1 dated 28 March 2019, as determined by Section 79(1) of the Swartland Municipality: Municipal Land Use Planning By-Law (PG 8226 of 25 March 2020), the application for consolidation of Erven 1819 & 1820, Yzerfontein, is hereby approved in terms of Section 70 of the By-Law, subject to the following conditions:

#### **1. TOWN PLANNING AND BUILDING CONTROL**

- (a) Erf 1819 be consolidated with erf 1820, Yzerfontein as proposed in the application;
- (b) A general plan or diagram be submitted to the Surveyor General, including proof to the satisfaction or the Surveyor General of:
  - (i). The municipality's decision to approve the consolidation;
  - (ii). The conditions of approval imposed in terms of section 76 of the By-Law; and
  - (iii). The approved consolidation plan;

#### **2. WATER**

- (a) The consolidated erf be provided with a single water connection;

#### **3. SEWERAGE**

- (a) The consolidated erf be provided with a single conservancy tank with a minimum capacity of 8000litres be provided which is accessible for the services truck from the municipal street;

#### **4. GENERAL**

- (a) The approval does not exempt the applicant from adherence to any and all other legal procedures, applications and/or approvals related to the intended land use, as required by provincial, state, parastatal and other statutory bodies;
- (b) The legal certificate which authorises transfer of the consolidated portions, in terms of Section 38 of the By-Law, will not be issued unless all the relevant conditions have been complied with;

- (c) In terms of section 76(2)(w) of the By-Law, this approval is only valid for a period of 5 years. All conditions of approval be complied with before transfer on the consolidated erf takes place and failing to do so will result in this approval expiring.

Yours sincerely

  
MUNICIPAL MANAGER  
per Department Development Services  
HLO/ds

Copies: The Surveyor General, Private Bag X9028, Cape Town, 8000  
Director: Civil Engineering Services  
Director: Financial Services  
R Steenkamp & DCW Edwards, 7 Kalkoond Crescent, YZERFONTEIN, 7351  
[reno@houseofnomad.com](mailto:reno@houseofnomad.com)  
[planning2@rumboll.co.za](mailto:planning2@rumboll.co.za)

# CONSOLIDATION OF ERVEN 1819 AND 1820, YZERFONTEIN

SWARTLAND MUNICIPALITEIT  
SWARTLAND MUNICIPALITY

Konsolidasie toegestaan ingevolge artikel 70 van die Verordening insake munisipale Grondgebruikbeplanning (PK 8226 van 26 Maart 2020) onderhewig aan voorwaardes.

1772  
Consolidation granted in terms of section 70 of the Municipal Land Use Planning By-Law (PN 8226 of 25 March 2020), subject to conditions.

2026/01/08  
DATE

MUNICIPAL BESTUURDER  
MUNICIPAL MANAGER

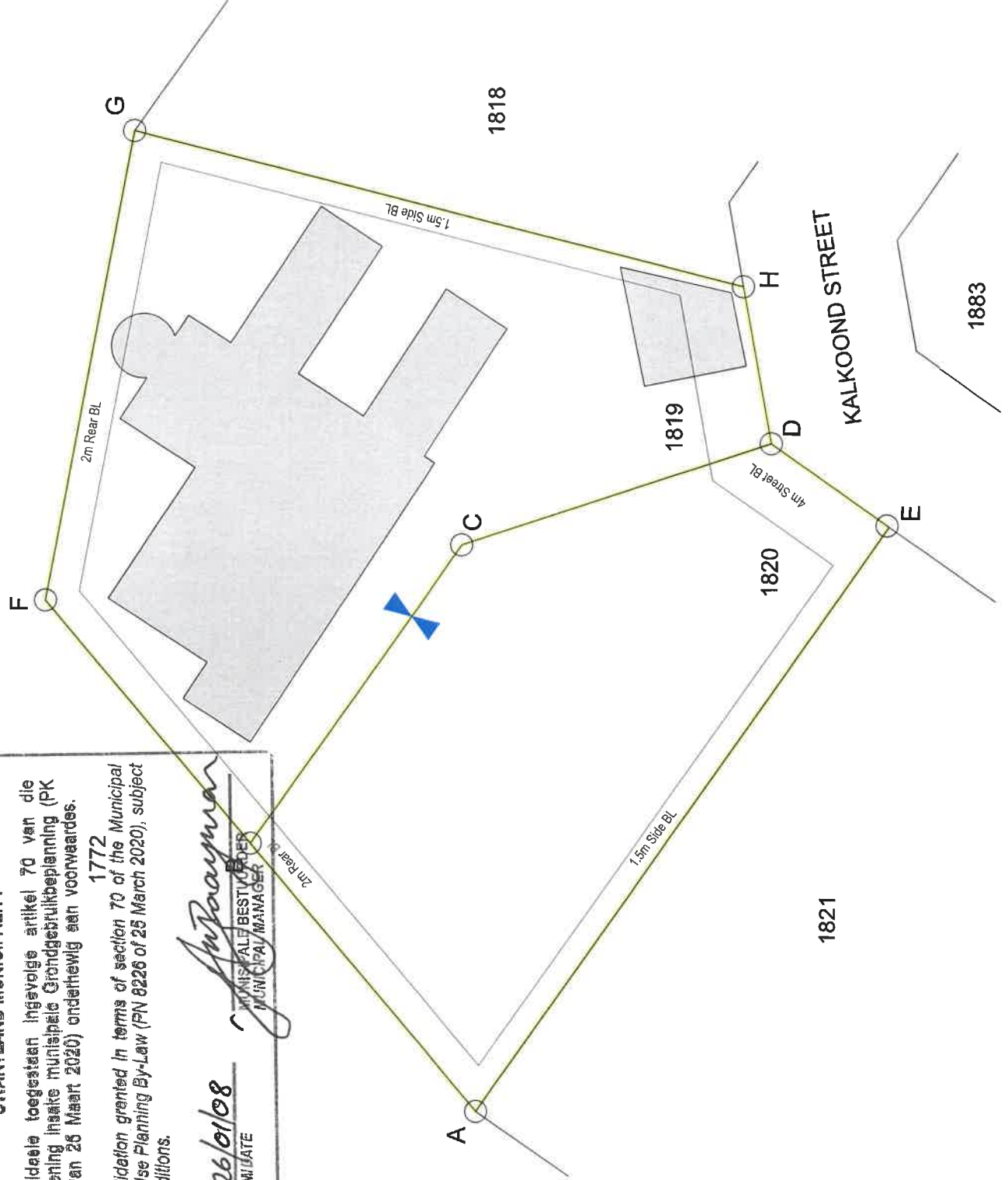

## NOTES:

Figure A B C D E represents Erf 1819  
Yzerfontein which measures  $\pm 1093\text{m}^2$ .

Figure B F G H D C represents Erf 1820  
Yzerfontein which measures  $\pm 797\text{m}^2$ .

Consolidation

Existing structures

Erf Boundaries

Zoning: Residential Zone 1

Consolidation:  
Erf 1819 -  $1093\text{m}^2$   
Erf 1820 -  $797\text{m}^2$

Total:  $1890\text{m}^2$

Consolidation of erven 1819 and 1820, Yzerfontein

ALL AREAS AND DISTANCES ARE SUBJECT TO SURVEYING

C.K. RUMBOLD & VENNOTE  
TOWN PLANNERS  
PROFESSIONAL SURVEYORS  
16 PAMIER STREET, MALMESBURY  
T: 012 221 4821/845  
F: 012 221 4871/661  
Email: planning@rumbold.co.za

DATE:  
October 2025

AUTHORITY:  
SWARTLAND MUNICIPALITY

REF:  
YZER/4820/LJK

SCALE: NTS